

CUSTOMER

# CAN ART STD.

DIE No.

EH05818

REV. No.

1

DESCRIPTION

3" x 2" x .125" RECT. TUBE W/ RADS.

CUSTOMER PART No.

QUOTE No.

06-0268-1

PROPOSAL No.

H-16807

NOTE: BREAK ALL CORNERS WITH 0.015" (.38 MM) RADIUS UNLESS OTHERWISE NOTED. STANDARD TOLERANCES TO APPLY UNLESS OTHERWISE SPECIFIED.

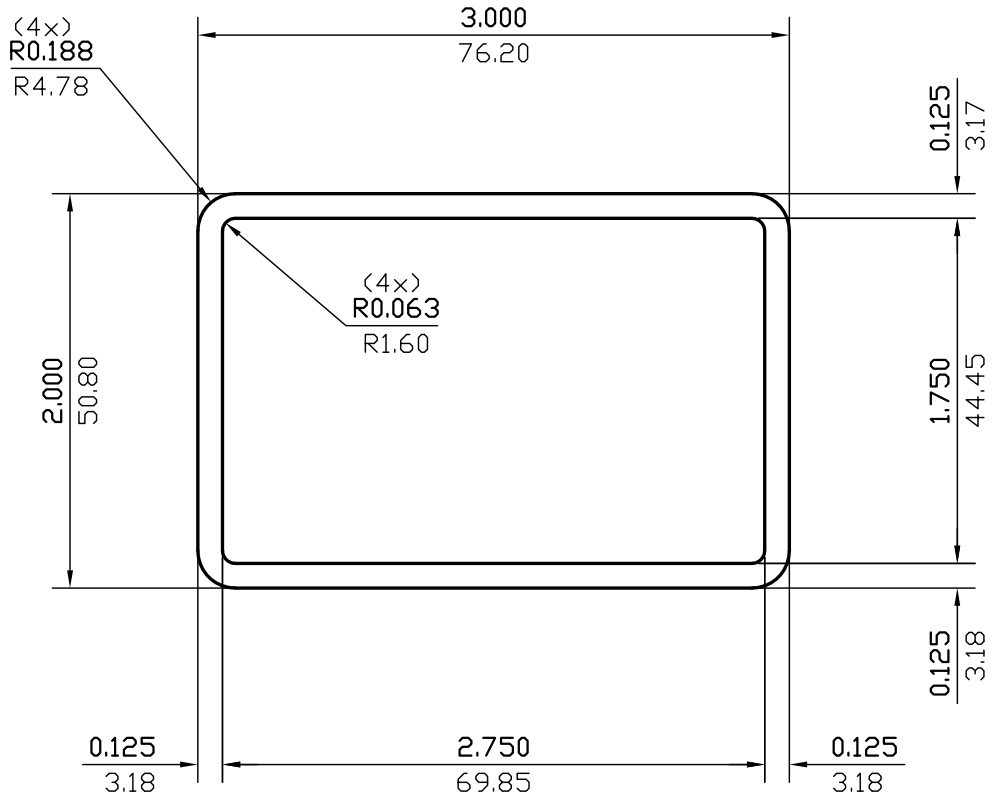

WALL THICKNESS 0.125(3.18) EXCEPT AS SHOWN

DATE	REV	DESCRIPTION	BY
03/15/23	1	REMOVED ALLOY	JASON
EST.AREA	1.161	IN. <sup>2</sup>	EST.AREA 748.758
			MM. <sup>2</sup>
EST.WT.	1.369	LBS/FT.	EST.WT. 2.038
			KG/M.
EST.PER.	18.569	IN.	EST.PER. 471.655
			MM.
OUT PER.	9.677	IN.	OUT PER. 245.8
			MM.
C.C.D.	3.461	IN.	C.C.D. 87.897
			MM.
FINISH	M/F		ALLOY
CKD BY	FACTOR 14	SCALE 1:1	DWN BY C.P. DATE 04/18/2006

# CAN ART

ALUMINUM EXTRUSION INC.

85 PARKSHORE DRIVE  
BRAMPTON, ONT L6T 5M1  
TEL. NO. (905) 791-1464  
FAX NO. (905) 791-9151  
WEB: www.canart.com

THIS DRAWING IS NOT NECESSARILY A COPY OF YOUR ORIGINAL. PLEASE APPROVE DIMENSIONS AND TOLERANCES INDICATED. CAN ART ASSUMES NO RESPONSIBILITY EITHER TECHNICAL OR LEGAL FOR HAVING THIS SHAPE MADE. THE CUSTOMER AGREES TO FULLY PROTECT CAN ART ALUMINUM FROM CLAIMS OF OTHERS RESULTING FROM THIS SHAPE.

SIGNED: \_\_\_\_\_ DATE: \_\_\_\_\_